

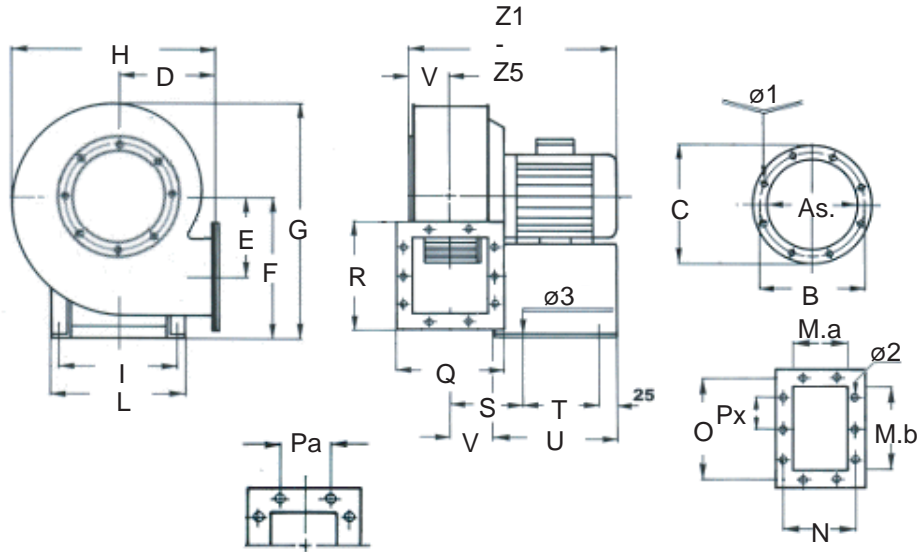

Radial blowers MB-Series

Volumetric flow rate: 500 - 30000 m³/h
Pressure: up to 15691 Pa

The fans of the MB series are particularly suitable for conveying clean or slightly dusty air up to a maximum temperature of 80°C. This series is used for private and industrial ventilation, heating and air conditioning systems. The spiral housings are made of welded or folded sheet steel. The rotors are made of sheet steel and are equipped with curved blades and are statically and dynamically balanced. The impeller is mounted directly on the motor shaft.



Type	MB 200	MB 250	MB 300	MB 350	MB 400	MB 450	MB 500	MB 550	MB 600
As.(mm)	200	250	300	350	400	450	500	550	600
B (mm)	232	282	332	382	432	482	532	582	632
Ø 1	M8	M8	M8	M8	M8	M8	M8	M8	M8
C (mm)	260	310	362	412	462	515	565	615	665
D (mm)	155	175	205	235	265	295	325	365	395
E (mm)	140	180	220	260	300	340	380	410	445
F (mm)	260	320	380	445	505	565	625	685	745
G (mm)	425	525	625	735	835	935	1040	1140	1240
H (mm)	340	420	500	580	660	740	820	910	990
I (mm)	230	230	230	290	340	390	400	400	440
L (mm)	255	255	255	320	370	420	440	440	480
M.a (mm)	160	200	240	280	320	360	400	440	480
M.N (mm)	160	200	240	280	320	360	400	440	480
N (mm)	192	232	272	318	358	400	440	480	520
O (mm)	192	232	272	318	358	400	440	480	520
Pa (mm)	90	90	90	90	100	100	100	100	100
Px (mm)	1x90	1x90	2x90	2x90	2x100	3x100	3x100	4x100	4x100
X/Ø 2 (mm)	8x9	8x9	12x9	12x9	12x9	6x9	16x9	20x9	20x9
Q (mm)	215	255	295	345	385	425	465	516	556
R (mm)	215	255	295	345	385	425	465	516	556
S (mm)	135	155	175	201	221	241	261	281	301
T (mm)	135	175	175	225	300	360	360	420	420
Ø 3 (mm)	9	9	9	9	9	9	9	9	9
U (mm)	210	250	250	305	380	440	440	500	500
V (mm)	86	106	126	146	166	188	210	230	250
Z1 (mm)	370	410	480	555	635	740	825	865	980
Z2 (mm)	390	440	505	595	660	780	825	940	1000
Z3 (mm)		410	480	595	695	855	900	960	1025
Z4 (mm)				555	635	705	785	865	980
Z5 (mm)						740	825	940	1000
Gewicht (kg)	22	26	36	60	110	190	200	240	330

